

Padlock 2E

Quick Reference Guide

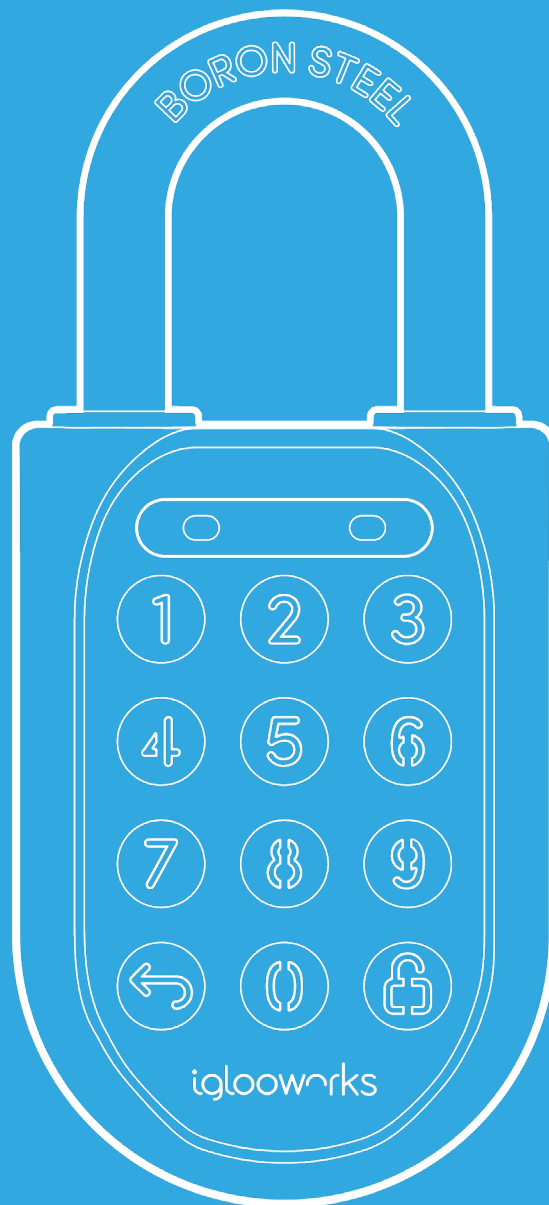

Contents

What's in the box.....	3
Charging the Battery.....	4
Setting up the lock.....	5
Installing the lock.....	6
Audio and LED indications.....	7
Hard Reset.....	8
Troubleshooting.....	9
Specifications.....	10
Lock Anatomy.....	11

What's in the Box?

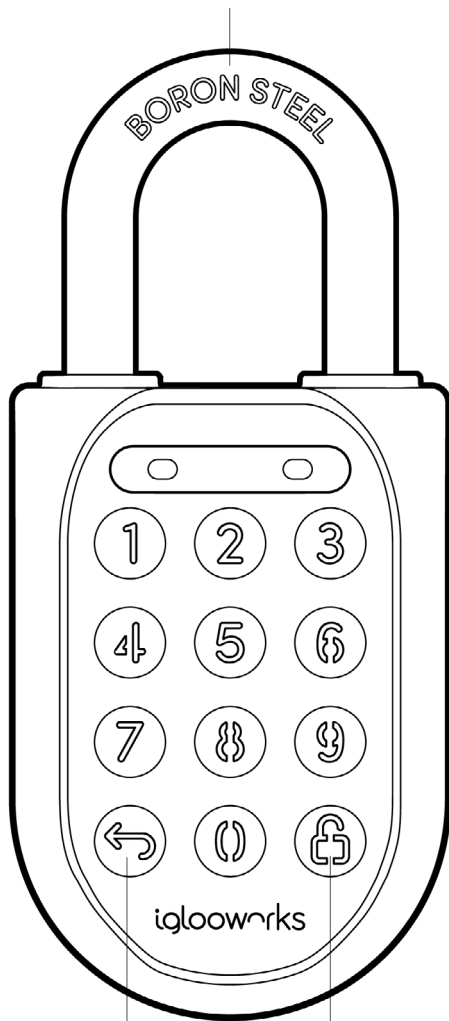

Padlock



**USB C
Charging Cable**



**Torx
Screwdriver**



Mounting Screw

Charging the Battery

It is recommended that you fully charge the Padlock 2E before usage.

Charging requirements: Prescribed charger is 5V 1A (5W).

Charging time: 30 minutes to 50% and 1 hour for 100% battery level

Charging via the USB-C port on the Padlock 2E

1. Connect the USB cable into the USB-C port on the Padlock 2E
2. Insert the other end of the cable into a USB-C Power Adapter (not provided) and plug it into a power outlet.

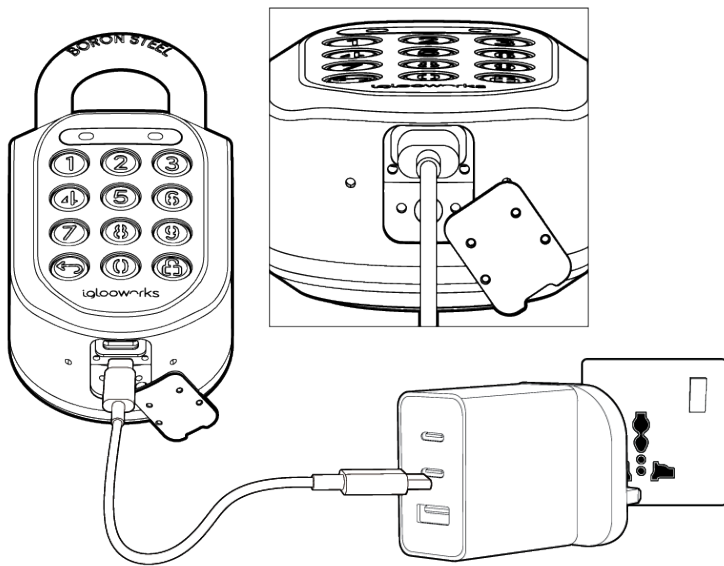

LED Indications for charging status

1. Fully charged - Breathing green LED
2. Charging - Breathing red LED

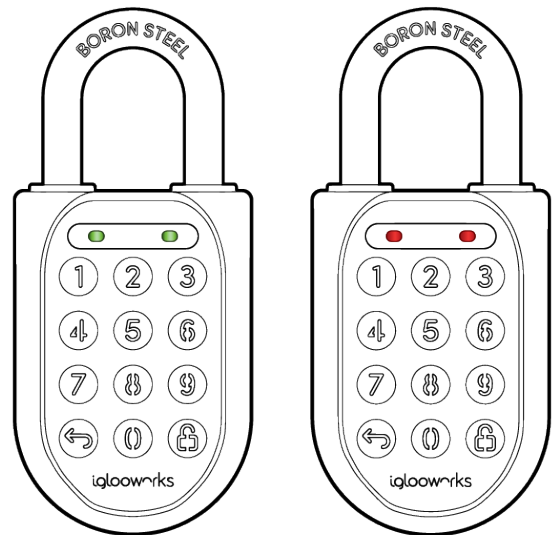

Setting up the Lock

It's time to get it paired to your phone and connected to ClubSpark. Step by step instructions will guide you through this process.

What you need:



Credit / Debit Card*



Smartphone



ClubSpark Admin Access

Time Required:

30-40 Minutes

Open your camera app on your phone and scan the QR codes below.



Part One

Pairing the lock to your phone.



Part Two

Connecting the lock to your Clubspark account.

Having issues with scanning?

tennis.kiwi/setup
clubspark@tennis.kiwi

* No other payment alternative option available, your venue may need to apply for a card.

Installing the lock

When the venue is ready to attach the lock to the gate, there are a few ways you can do this*. You may need to modify the gate slightly. Most gate latches have ample space to accomadate the shackle.

Example One:

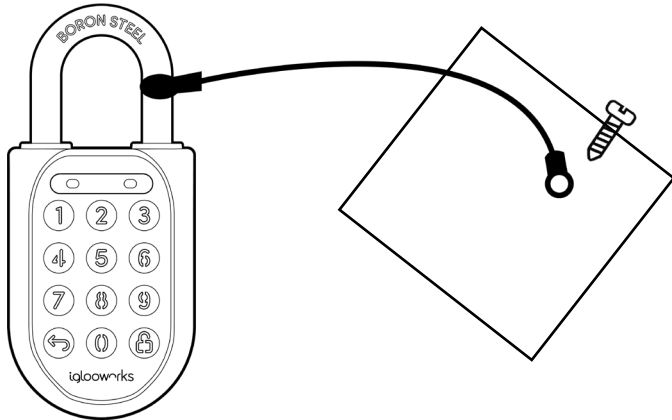

Screws

Affix the screw on a sturdy board / wall using the supplied screw.

Example Two:

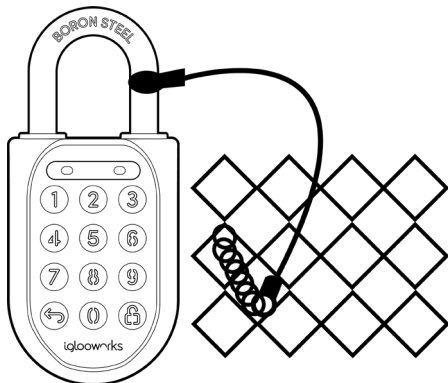

Chains

Chain the cable to the fence using the supplied screw as a hold.

Example Three:

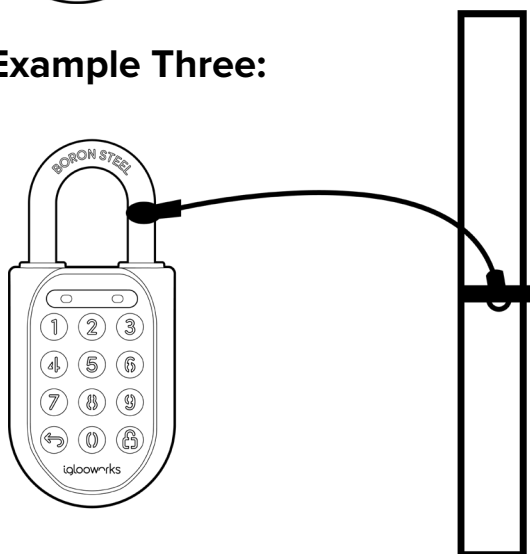

Stainless Steel Cable Ties

Stainless Steel ties are great option to attach the lock cable to the gate frame.

*Installation will vary depedning on existing setup
Examples are above are provided as a guide and may differ to your clubs requiements.

Audio & LED Indications

Actions	Indications
Bluetooth Connection	LED Indicator flashes Blue
Successfully Unlocked	Ascending 4 fast tones after unlocked and flash Green LED 2 times
Successfully Locked	1 long beep after Padlock is locked and Green LED for 2 seconds
Incorrect PIN Code	4 short beeps and flash Red 2 times
Deleted PIN Code	3 sets of 4 short beeps and flash Red 2 times
Obstruction Alarm	6 sets of 4 short beeps and flash Red 2 times
Security Lockout Alarm	Low - High siren for 30 / 60 / 90 seconds and flash Red 2 times
Security Lockout Deactivated	2 long beeps
Charging in Progress	Breathing red LED flash when USB-C is connected
Charging Completed	Breathing green LED flash when USB-C is connected
Low Battery Alert	Descending 3 fast tones when keypad is woken up and breathing Red LED
Hard Reset / Unpair	Descending 4 slow tones
Power Start Up	1 long beep then 2 quick beeps

Hard Reset

To Hard Reset your lock:

1. Hold the button for 10 seconds,
2. After 10 seconds the lock will enter a hard reset state and give out one long beep with red flashing light.
3. Key in the Master PIN followed by the padlock button.
4. If the Master PIN is entered correctly you will hear another long beep and the red light will change to green.

Note: The Hard Reset State only lasts 10 seconds, if the code is not entered fast enough you will have to restart the process.

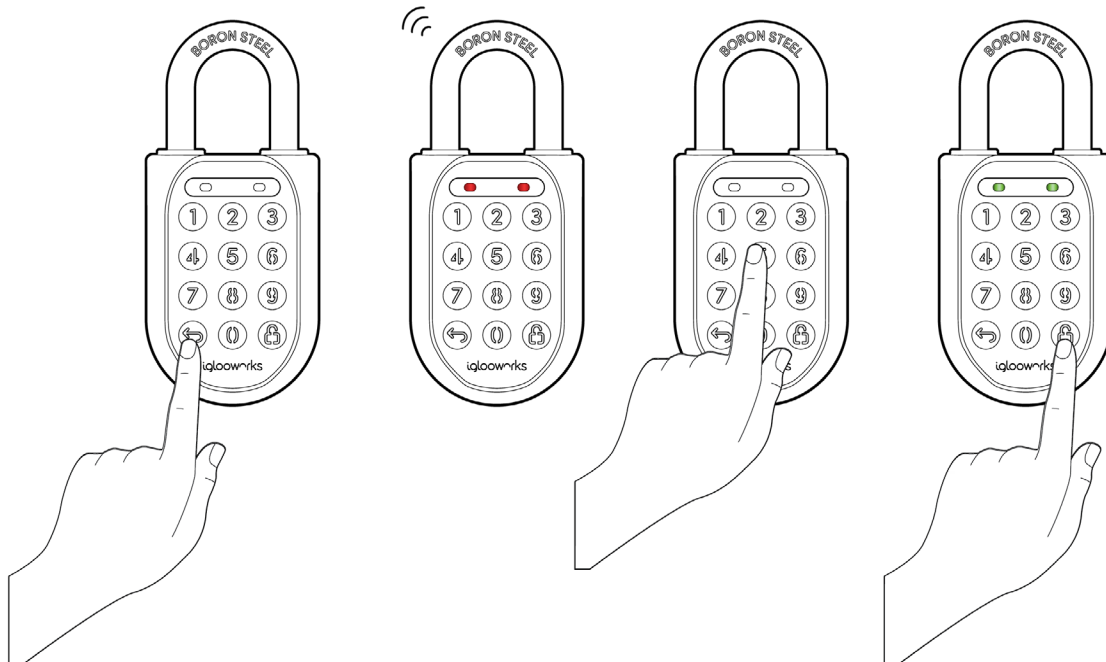

Troubleshooting

Hardware Troubleshooting

I am unable to close the shackle to lock the padlock.

- Do an unlock via PIN code or Bluetooth and try to close the shackle again.

Note: The padlock can be manually locked by holding the unlock button for 2 seconds when the padlock is open.

The padlock keypad flashes white and LED indicator flashes red when I activate the keypad.

Security Lockout is triggered on the Padlock 2E.

I was unable to jumpstart the lock using USB-C.

- Please ensure USB-C connector is connected to the USB-C slot securely while unlocking it with PIN code or Bluetooth.
- Please unlock within 20 seconds.
- Please ensure that the Power Bank has sufficient power.

The lock is not responding at all.

- The Padlock 2E's battery is flat.
- Use the USB C cable to jumpstart the lock and unlock it.
- Charge the lock to continue using it. Please ensure that the lock is fully charged before your next deployment.

I closed the shackle but the padlock did not relock automatically.

- Make sure Auto Lock is ON via the iglooworks mobile app.
- If Auto Lock is ON and the padlock is still not working, try to lock the padlock manually by holding the UNLOCK button for 2 seconds.

I tried to unlock the Padlock 2E but the keypad went off and came back on with 2 slow and 2 quick beeps.

- The Padlock 2E is low in battery.
- Use an USB-C cable connected to a power bank to jumpstart the lock and unlock the Padlock 2E to replace the batteries.

Refer to Page 4 for charging of battery.

Specifications

SKU	SP2E
Body	Zinc Alloy, Stainless Steel, Rubber
Shackle	Boron Steel
Gross (with packaging)	0.5kg / 1.1 lbs
Net	0.5kg / 1.1 lbs
Modes of access (Entry)	Pin Code, Bluetooth
Power type	Rechargeable Lithium battery
Battery life	Up to 12 months*
Emergency power type	USB-C jumpstart
Battery operating temperature	-20 to 50°C / -4°F to 122°F
Operating temperature	-30°C to 55°C / -22°F to 131°F
Certifications	IPX8, CE, RoHs2, FCC, CEN-3, IK-09, ISED, GITEKI, UKCA
Protocols	Bluetooth 5.0, algoPIN™ technology
Usage	Suitable for both indoor and outdoor usage

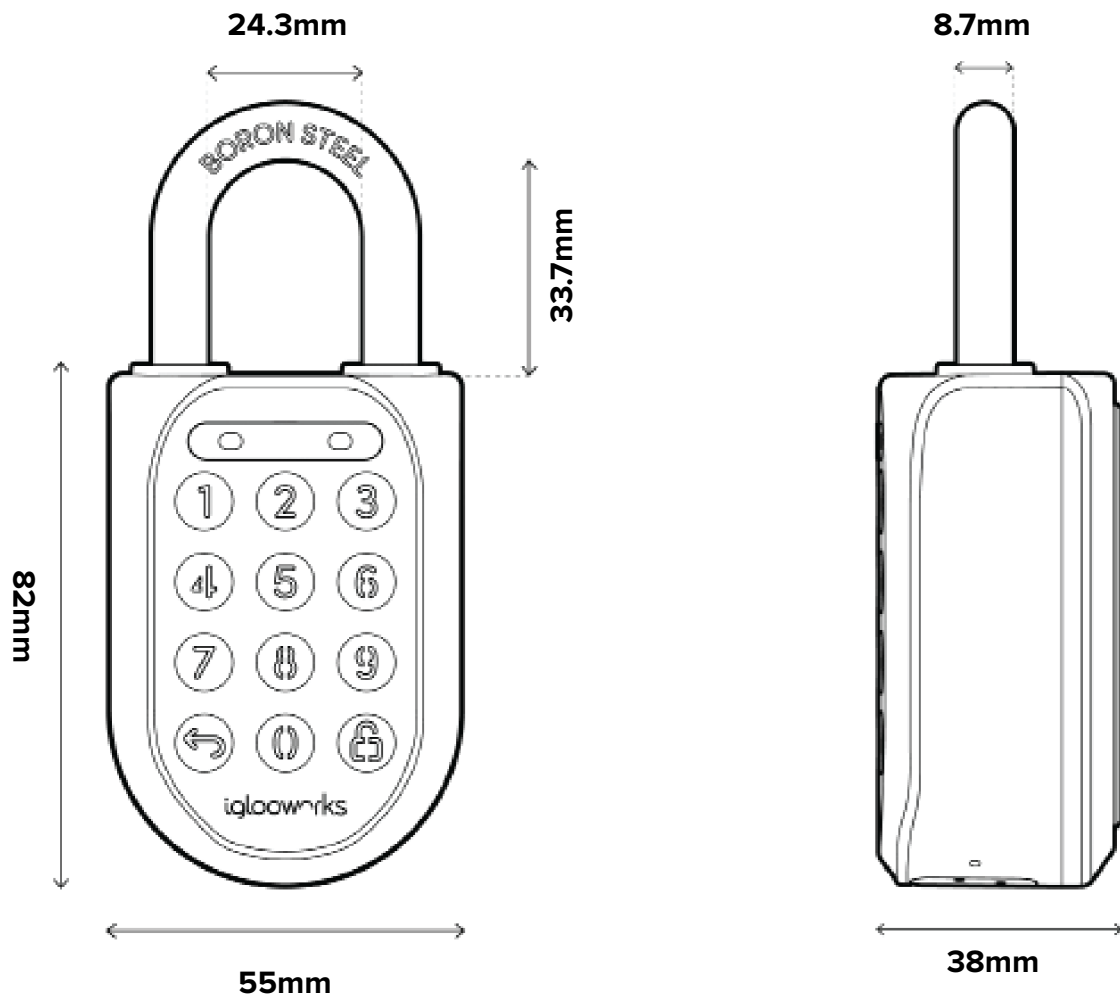

Lock Anatomy

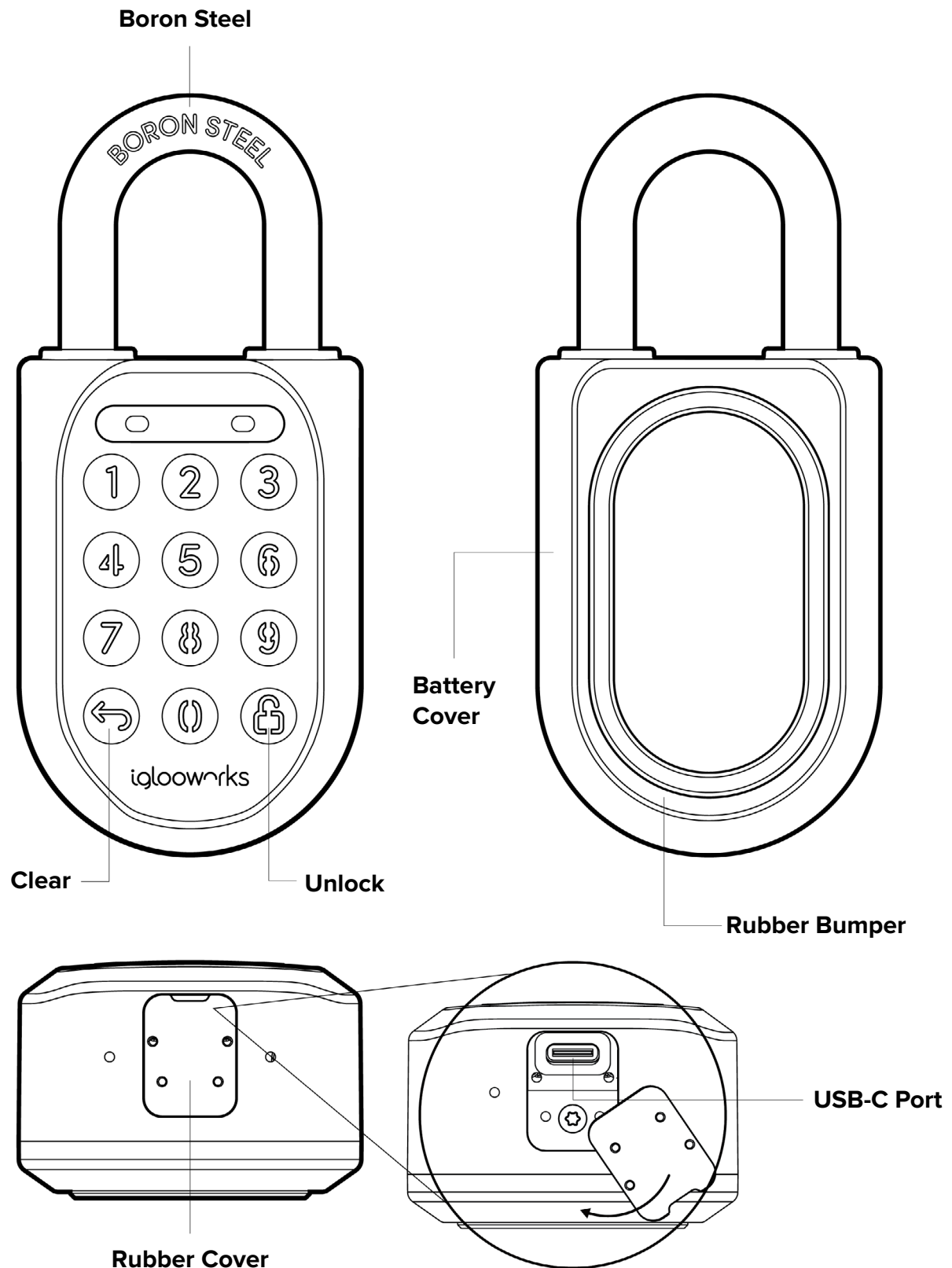



book a court 
court hire made easy